

7EA/7B Transition Piece

CPI is the largest and most reliable after-market source of GE style transition pieces, with over 2,500 transition pieces installed today. CPI's 7EA and 7B TPs, first delivered in 2001, are equivalent to the OEM in fit, function, quality and warranty period, but are available to our customers at lower costs and with shorter lead times.

- Over 1,100 7EA/7B Transition Pieces installed to date.
- All 7EA transition pieces are constructed from an advanced Nimonic alloy for improved high temperature strength and longevity.
- Thermal Barrier coating (TBC) lines the aft 17-inches of the interior to enhance durability, and chrome carbide coating protects the inlet end against wear from the combustion liner.
- 100% over-inspection of all Frame 7 transition pieces by an independent firm.

Assembly Options for 7EA Transition Pieces:

- Dilution holes in TP body, cooling holes in aft frame, wear kit of L-605 aft frame inserts and FSX-414 H-blocks to extend useful life, articulating aft bracket to ease installation and reduce vibration, blunt end modification to seals, and full body TBC.

Assembly options for 7B Transition Pieces:

- Aft stiffener rib, Cooling holes in body, TBC coating, upgrade from Hastelloy X body to Nimonic 263.



7EA/7B Transition Piece

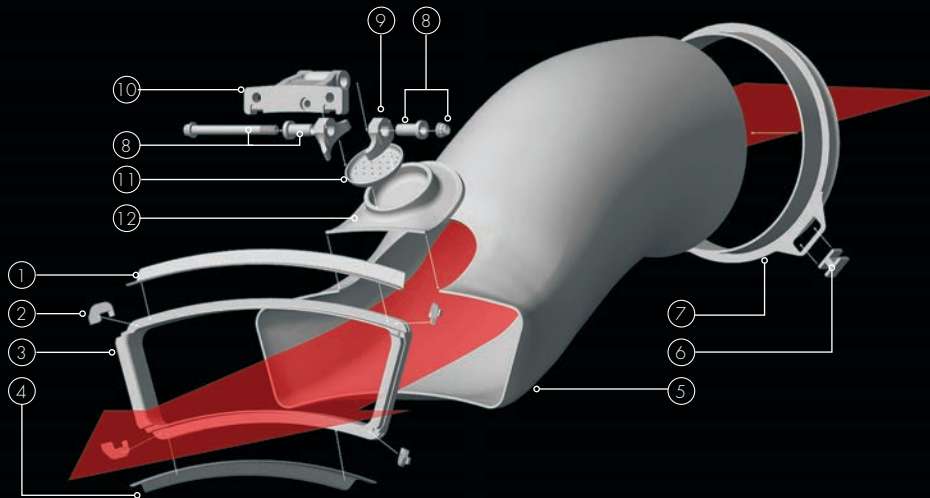

- 1. Outer Floating Seal
- 2. Rat Ear
- 3. Aft Frame
- 4. Inner Floating Seal
- 5. Body
- 6. H Block
- 7. Inlet Sleeve
- 8. Aft Bracket Hardware
- 9. Aft Bracket Lugs
- 10. Aft Bracket
- 11. Vent Plate
- 12. Basemount

7EA/7B Transition Piece Assembly Options

Description	CPI Part Number
Nimonic 263 7EA transition piece assembly	7EA-0236-G023
As above, except add 210 cooling holes in aft frame	7EA-0236-G026
As above, except add 2 dilution holes in body of transition piece	7EA-0236-G029
L-605 wear guards in aft frame slots, upgraded FSX-414 H-blocks suitable for wear wrappers on bullhorn brackets	Add "W" to any part number above
Nimonic 236 7EA transition piece assembly with articulating bracket	7EA-2021-G001
Hast-X 7B transition piece assemblies	7B-0143-G008

7EA Transition Piece Detail Parts

Description	CPI Part Number
Aft Frames (standard, "wear kit" slot width, or Barnes Handle frame)	7EA-0236-G023-2-1, 7EA-0236-G026-2-2, & 7EA-2021-G001-2
Aft Bracket, Bracket Risers, and Bracket Hardware	7EA-0236-G023-4, 7EA-0236-G023-5, Various
Floating Inner/Outer/Side Seals	7EA-0236-G023-17, 7EA-0236-G023-18, 7EA-0236-G023-20
Cloth Inner/Outer/Side Seals	7EA-2021-G001-19, 7EA-2021-G001-20, 7EA-2021-G001-21
Wear Guards	7EA-0236-G023-14, -15, and -16, 7EA-2021-G001-5, -6, and -7
H-Blocks (Hast-X or FSX-414 in multiple sizes)	6B-2572-6, 6B-2572-11
Bullhorn Brackets (Standard, various wear guards, wear coatings)	7E-7407-G004, 7E-7407-G004W

